

**NOTE: DO NOT DISCARD the Parts List from the Instruction Bulletin. Place the Parts List in the appropriate place in the machine manual for future reference. Retaining the Parts List will make it easier to reorder individual parts and will save the cost of ordering an entire kit.**

*NOTE: Numbers in parenthesis ( ) are reference numbers for parts listed in Bill of Materials.*

Installation instructions for **kit number 9009852**

**SYNOPSIS:**

This kit contains the parts needed to install a spray nozzle kit onto T12 scrubbers. Please follow step-by-step instructions.

**SPECIAL TOOLS / CONSIDERATIONS: NONE**

(Estimated time to complete: 5 hours)



**PROTECT THE ENVIRONMENT**

Please dispose of packaging materials, used machine components such as batteries and fluids in an environmentally safe way according to local waste disposal regulations.



Always remember to recycle.

**PREPARATION:**

1. Completely empty both the solution tank and the recovery tank.
2. Park the machine on a clean level surface.
3. Remove the brushes from the scrub head and completely lower the scrub head. Machines with cylindrical scrub heads only: Remove the debris tray.
4. Turn off the machine and and remove the key.

**FOR SAFETY: Before leaving or servicing machine, stop on level surface, turn off machine, and remove key.**

5. Disconnect the battery cable from the machine.



**WARNING: Always disconnect battery cables from machine before working on electrical components.**

6. Remove the existing vacuum fan compartment cover from the machine. Set the mounting hardware aside. Discard the vacuum fan compartment cover. (Fig. 1)

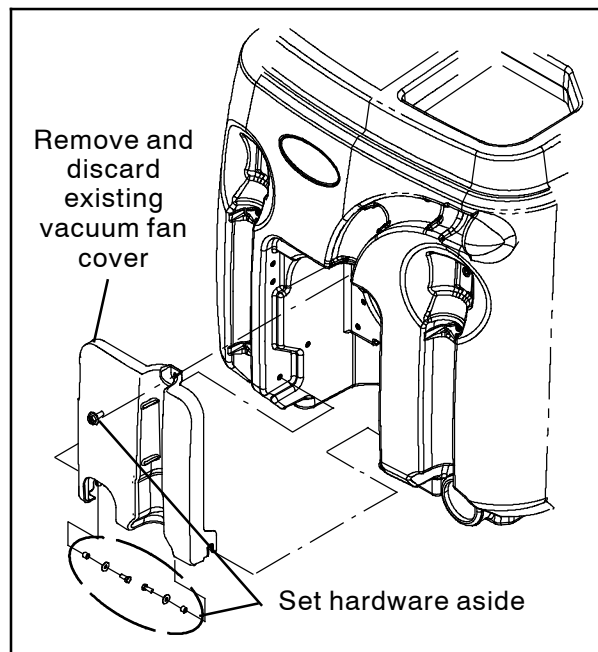

**FIG. 1**

## INSTALLATION:

**NOTE: Do Not** cut the band holding the spray hose into the spray hose reel until after the spray hose assembly is installed onto the machine.

**NOTE: Refer to RESETTING REEL ASSEMBLY SPRING TENSION** at the end of this IB for instructions how to reset the reel assembly tension for the spray hose if the hose should come unwound from the reel assembly.

1. Use four M6 hex screws (4), four flat washers (5), and four M6 hex nuts (6) to install the solution pump (1) onto the pump bracket (3). (Fig. 3)
2. Cut a 14.5 in. (368 mm) and a 63 in. (1600 mm) length of PCV hose from the 96 in. (2438 mm) PVC hose (8).
3. Use a hose clamp (9) to install the 14.5 in. (368 mm) PVC hose (8) and 63 in. (1600 mm) PVC hose (8) onto the solution pump (1). (Fig. 3)
4. Use a M8 SEMS hex screw (7) to install the pump bracket (3) / solution pump (1) onto the frame of the machine. (Fig. 3)
5. Connect the main wire harness to the solution pump (1). (Fig. 3 / Fig. 4)
6. Connect the diode (2) to the main wire harness. (Fig. 3 / Fig. 4)
7. Remove filter screen located inside the solution tank from the solution fitting. Set screen aside. (Fig. 3)
8. Remove the solution fitting from the bottom of the solution tank. (Fig. 2)
9. Remove the plastic plug fitting from the back of the solution fitting assembly. Discard the plug fitting. (Fig. 2)
10. Install the 90° plastic fitting (12) onto the solution fitting assembly. (Fig. 3)
11. Reinstall the solution fitting onto the bottom of the solution tank. (Fig. 2 / Fig. 3)
12. Reinstall the filter screen inside the solution tank. (Fig. 3)
13. Use a hose clamp (9) to connect the 14.5 in (368 mm) PVC hose (8) to the 90° plastic fitting (12). (Fig. 3)
14. Route the 63 in. (1600 mm) PVC hose (8) under and behind the axle, along the back of the axle, to the vertical cavity in the right side of the solution tank, and up into the vacuum fan compartment. Use a cable tie to secure the 63 in. (1600 mm) PVC hose into place in the vacuum fan compartment. (Fig. 3)
15. Set the pre-assembled spray hose assembly into the vacuum fan compartment and use a hose clamp (9) to connect the 63 in. (1600 mm) PVC hose (8) to the 90° plastic fitting (31) on the top of the spray nozzle assembly. (Fig. 3)
16. Use two M6 hex screws (41) and two flat washers (5) to secure the spray hose assembly to the machine. (Fig. 3)
17. Use two M6 hex screws (41) and two flat washers (5) to secure the nozzle hook (40) to the machine. (Fig. 3)
18. Cut the band holding the spray hose in the spray hose reel.
19. Pull the spray nozzle and place it into the nozzle hook (40). (Fig. 3)

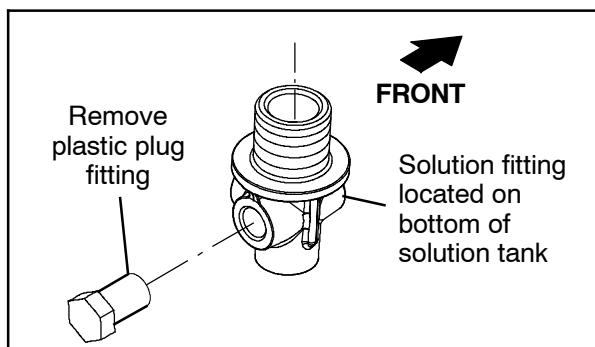

**FIG. 2**

9. Remove the plastic plug fitting from the back of the solution fitting assembly. Discard the plug fitting. (Fig. 2)

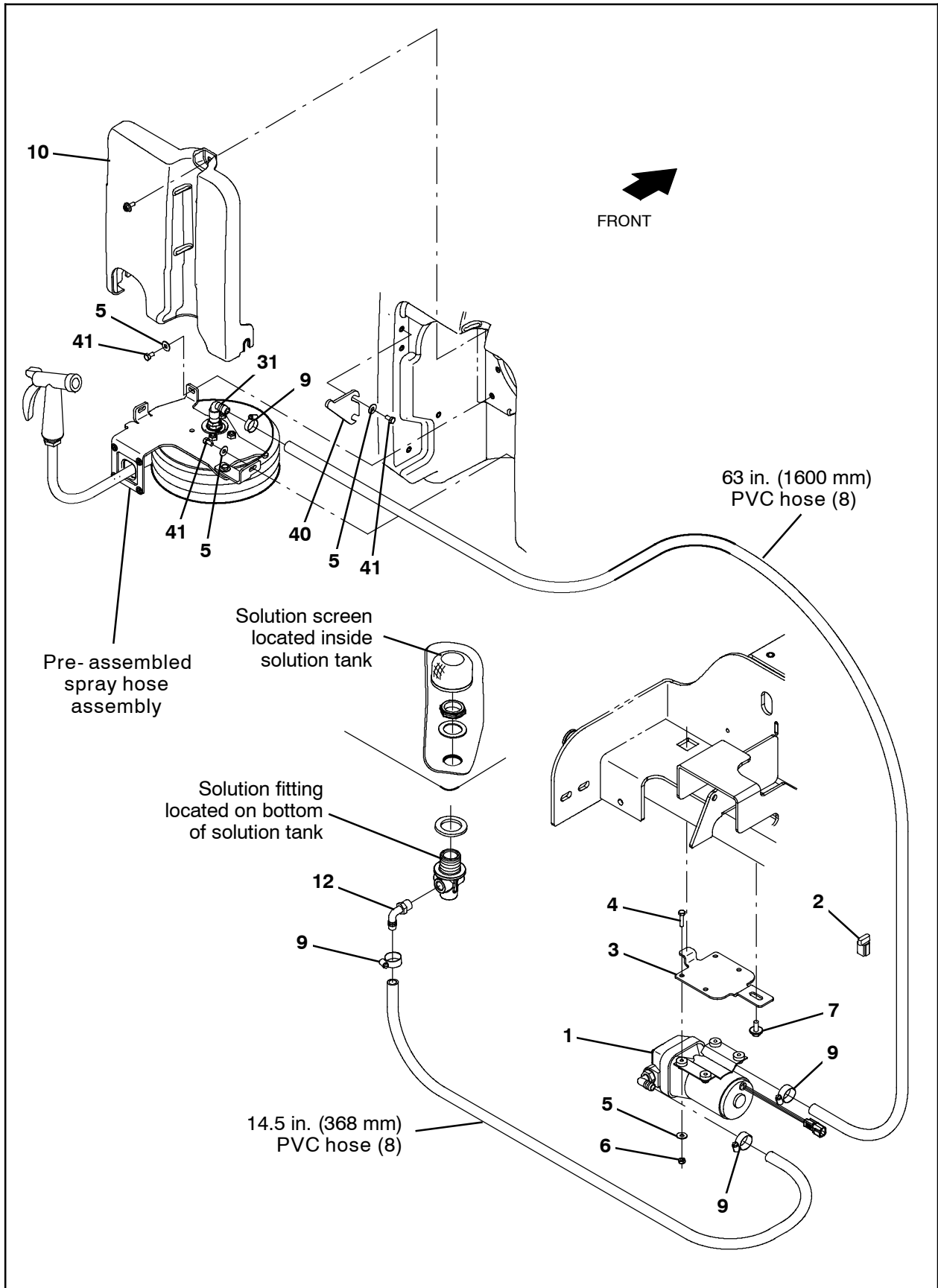

FIG. 3

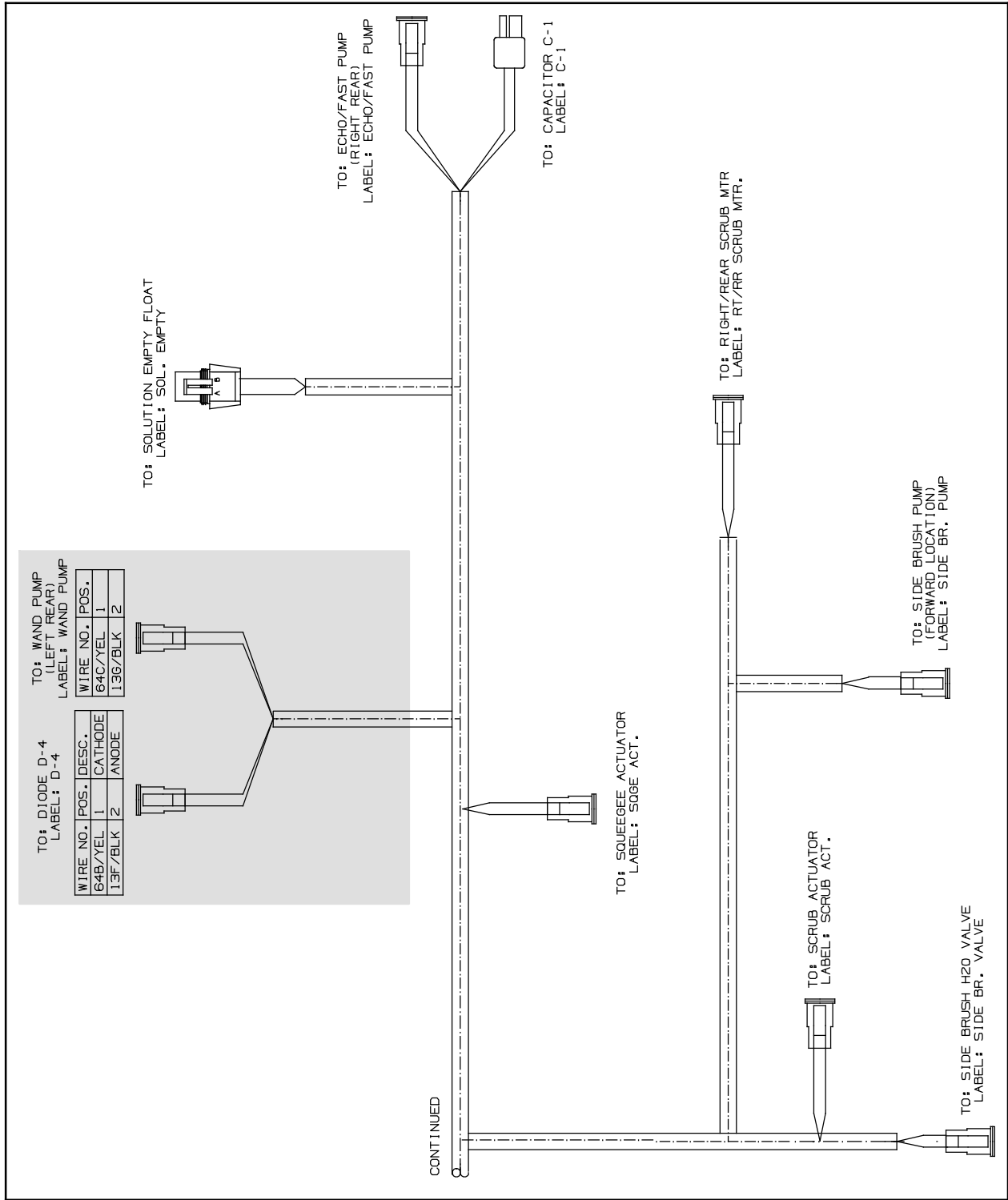
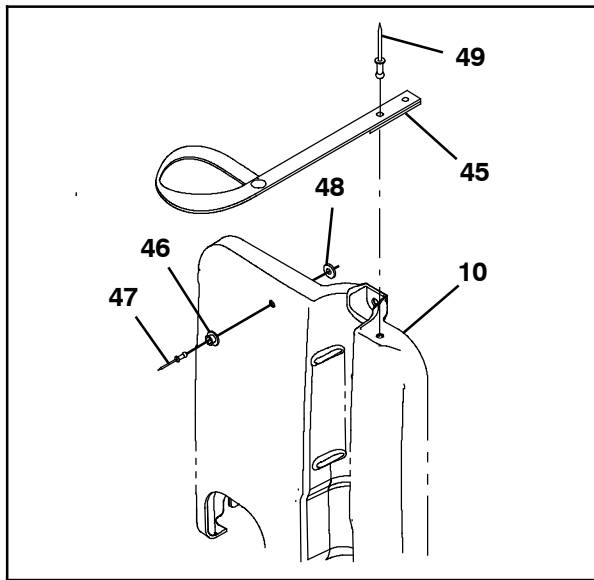

FIG. 4

20. **Machines equipped with optional vacuum wand only:** Use a blind rivet (49) to install the handle retainer strap (45) onto the new vacuum fan cover (10). (Fig. 5)



**FIG. 5 - Machines With Optional Vacuum Wand Only**

21. **Machines equipped with optional vacuum wand only:** Use a blind rivet (47) flat washer (48) to install the push snap catch (46) onto the vacuum fan cover (10). (Fig. 5)
22. Use saved hardware to install the new vacuum fan cover (10) onto the machine. (Fig. 1)

23. Remove the hardware securing the panel where the rocker switch (11) is to be installed and carefully lift the panel away from the front shroud. Do not break any wire / cable connections when lifting the panel from the machine. Set the hardware aside. (Fig. 6)

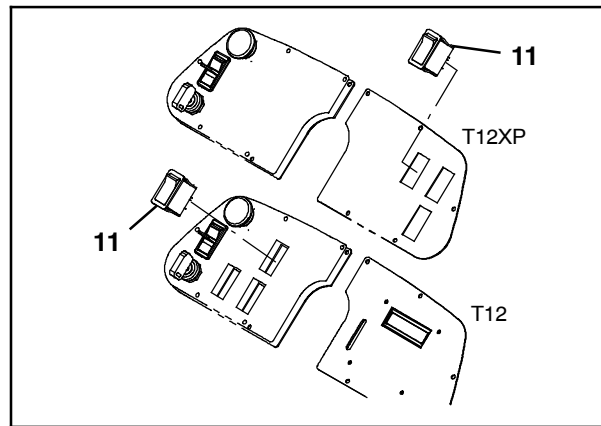

**FIG. 6**

24. Remove the blank from the location in the panel where the rocker switch (11) is to be installed. (Fig. 6)
25. Install the rocker switch (11) into the panel. (Fig. 6)
26. Connect the main wire harness to the rocker switch (11). (Fig. 6 / Fig. 7)
27. Reinstall the panel onto the front shroud. (Fig. 6)

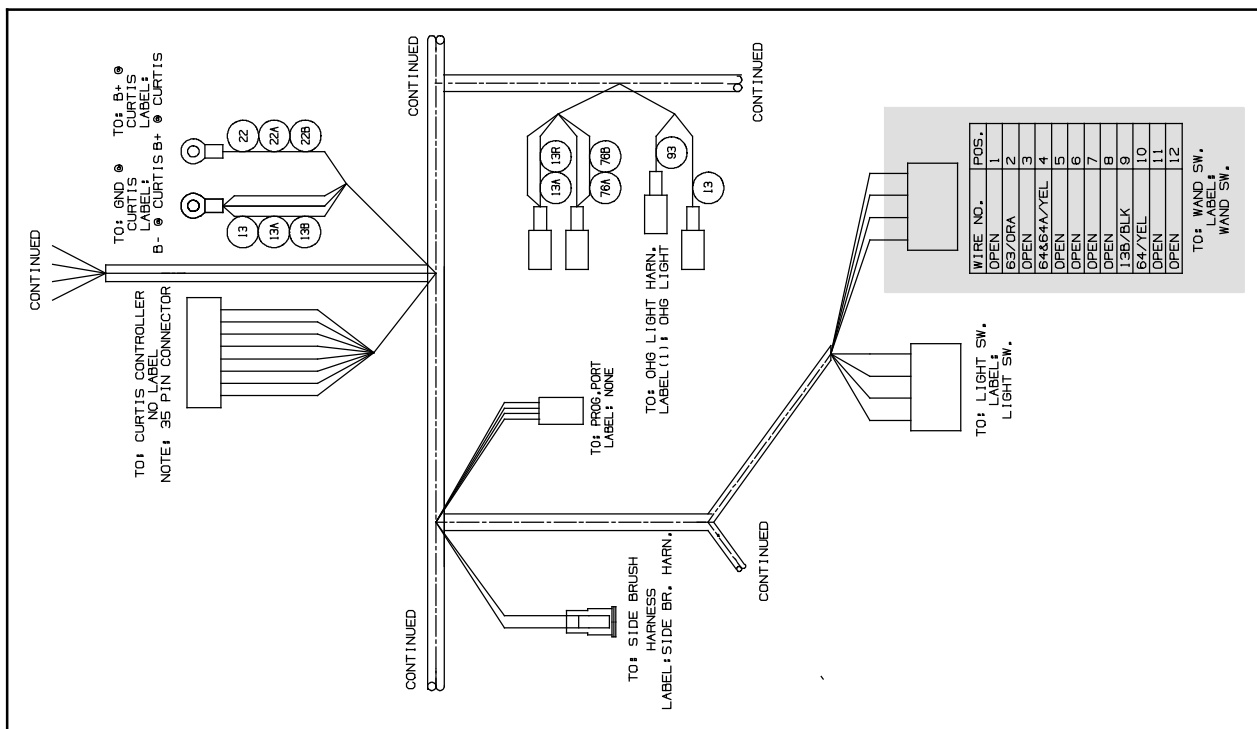

**FIG. 7**





36. Reconnect the battery cable to the machine.
37. Start and test the machine. Fill the solution tank. Operate the spray nozzle assembly to ensure it functions properly. Refer to Operator Manual for instruction how to operate spray nozzle.

#### **RESETTING REEL ASSEMBLY SPRING TENSION:**

*NOTE: Refer to Step 1 through Step 3 to reset the reel assembly spring tension on spray hose assemblies already installed on the machine. Refer to Step 4 to reset the reel assembly spring tension on spray hose assemblies not yet installed onto the machine.*

1. Wrap the spray hose (32) evenly back onto the reel assembly (14). (Fig. 13)
2. Pull the spray hose (32) out from the reel assembly (14) until the reel assembly has turned at least three revolutions, adding tension to the spring inside the reel assembly. (Fig. 14)

3. Wrap the portion of spray hose (32) pulled from the reel assembly (14) back onto the reel. (Fig. 14)
4. Rewind the spray hose (32) completely onto the reel (14) and rotate the spray hose assembly mounting plate (42) four complete turns clockwise to reset the spring tension. (Fig. 13)

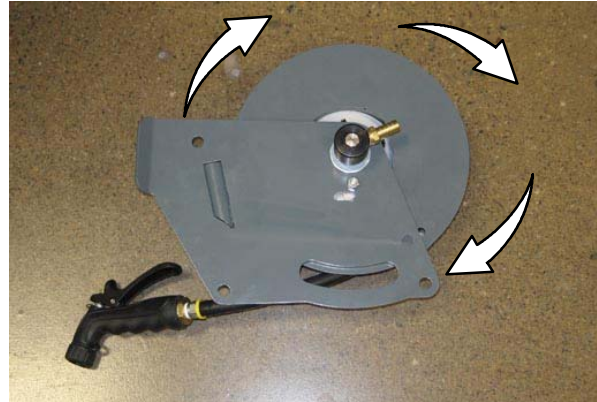

**FIG. 13**





Ref.	Part No.	Description	Qty.
6	08712	Nut, Hex, Lock, M6 X 1.00, NI, SS	4
7	1020341	Screw, Hex, M8 X 1.25 X 20, Ss, SEMS	1
8	376716	Hose, PVC, Brd, 0.50id 0.73od, Bulk, Clr - (96 in. / 2438 mm)	1
9	54333	Clamp, Hose, Wormdrive, 0.31- 0.88d, .31w	5
10	1202867	Cover, Access, Vacfan, Trimmed	1
11	398500	Switch, Rocker, Dpdt, On / None / On	1
12	64778	Fitting, Plstc, E90, Bm08/Pm06	1
13	1200239	Plate Wldt, Mtg, Hose- Reel [Cassoday]	1
14	1200313	Reel Assy, Hose, Small	1
15	1203947	Washer, Retainer, Spring	1
16	1201393	Pawl, Ratchet	1
17	08709	Nut, Hex, Lock, M8 X 1.25, NI	1
18	1056719	Bolt, Shld, .41d X 0.35, M8 X 1.25	1
19	1201423	Spring, Torsion, Hose Reel	1
20	24584	Fitting, Brs, E90, Pf06/Pm06, Spcl	1
21	1060128	Fitting, Brs, E90, Bm06/Pm06, Short	1
22	33584	Clamp, Cable, Stl, 0.63d X 0.50w, 1hole	1
23	06943	Screw, Hex, M6 X 1.00 X 20, 8.8	1
24	08708	Nut, Hex, Lock, M6 X 1.00, NI	1
25	1057816	Bushing, Sleeve, 1.00b 1.13d 1.750l, Fgl	1
26	1057814	Washer, Thrust, Plstc 1.02b 1.38d	1
27	32598	Washer, Flat, 1.02b 1.75d .12, Stl	1
28	09005	Ring, Retaining, Ext, 1.00d, Basic	1
29	1066919	Washer, Thrust, 50.0b 110.0d 0.79w	1
30	1200394	Fitting, Swivel, Str, Pm06/Pm06, Brs	1
31	47388	Fitting, Brs, E90, Em08/Pm06	1
32	1061087	Hose, Rbr, 0.38id, Bulk, Blk [Push- Lok] - (132 in. / 3353 mm)	1
33	1200665	Guide, Hose, Hdpe [Cassoday]	1
34	12323	Screw, Pan, Phl, M4 X 0.70 X 20, SS	4
35	01683	Washer, Flat, 10, SS	8
36	33932	Nut, Hex, Lock, M4 X 0.70, NI, SS	4
37	1060428	Fitting, Stl, Str, Bm06/Pm06, Swivel	1
38	1027976	Fitting, Brs, Str, Pf06/Pm12	1
39	769785	Nozzle, Spray, Gun	1
40	1201096	Hook, Nozzle, Hdpe	1
41	09744	Screw, Hex, M6 X 1.00 X 12, SS	6
42	1200732	Plate, Mtg, Hose Reel	1
43	08716	Screw, Hex, M6 X 1.00 X 20, SS	1
44	1064188	Circuit Breaker, 15.0A, Resettable	1
45	1061811	Strap, Retainer, Handle	1
46	1061812	Catch, Snap, Push, Mal	1
47	01335	Rivet, Blind, .125d X 0.44 X .25d, Alm	1
48	02892	Washer, Flat, 0.12b 0.38d .03, Stl. Pl	1
49	1067350	Rivet, Blind, .188d X 0.53 X .62d, Alm	1

TENNANT COMPANY  
P. O. Box 1452  
Minneapolis, MN 55440-1452